

## For general applications and for mildly corrosive chemicals



- Monobloc for rapid installation
- In permanent contact with the shaft with avoid all movement
- Interchangeable compatible counterfaces (Type IN)
- Difficult to clog
- **Temperature:** -40 °C to 180 °C (depending on material choice)
- **Pressure:** up to 26 bar (NBP) up to 30 bar (NBR)
- **Max Speed:** 20 m/s
- **Shaft size:** 10 to 70 mm

Performances shown above are minimum values for standard conditions of use; consult our technical experts for validation.

### COEFFICIENT OF CORRECTION OF RESISTANCE TO PRESSURE AND SPEED

	SELECTION FACTOR	COEFFICIENT
Nature of the fluid to be sealed	Petrol/gasoline, Kerosene	× 1
	Water, Aqueous solution	× 1
	Flashing hydrocarbons	× 0,75
Friction faces materials	Carbon vs. silicon carbide	× 1
	Carbone vs. alumina	× 0,8
	Silicon carbide vs. silicon carbide	× 0,6
Fluid temperature	T < 80° C	× 1
	80° C < T < 120° C	× 0,8
	120° C < T < 180° C	× 0,4
Speed	< 3 000 R.P.M	× 1
	> 3 000 R.P.M	× 0,85

### POSSIBILITY OF ASSEMBLY

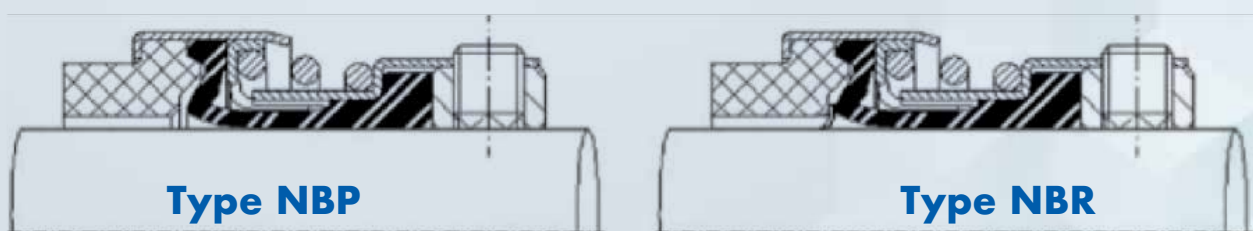

## DIMENSIONS OF NBP AND NBR SEALS AND SEAT IN (MM)

SHAFT DIAMETER	SEAL HEAD		SEAT
	External diameter	Working length	Designation
10	20	19	10- 21 -5
12	22	21	12- 23 -6
14	24	21	14- 25 -6
15	26	21	15 - 27 -6
16	26	21	16 - 27 -6
17	32	23	17 - 33 - 6
18	32	23	18 - 33 - 6
20	34	23	20 - 35 - 6
22	36	23	22 - 37 - 6
24	38	25	24 - 39 - 6
25	39	26	25 - 40 - 6
28	42	26	28 - 43 - 6
30	44	26	30 - 45 - 7
32	46	27	32 - 48 - 7
35	49	29	35 - 50 - 8
38	54	32	38 - 56 - 8
40	56	32	40 - 58 - 8
45	61	34	45 - 63 - 8
48	64	35	48 - 66 - 10
50	66	36	50 - 70 -10
55	71	37	55 - 75 - 10
60	80	40	60 - 80 - 12
65	85	40	65 - 85 - 12
70	90	47	70 - 92 - 12

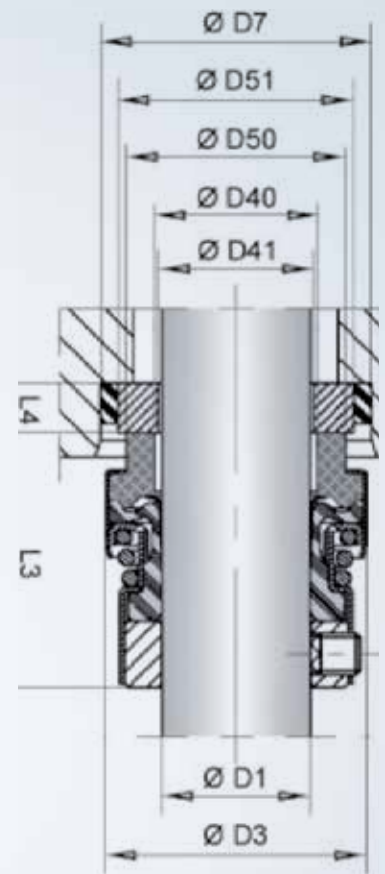

## DESIGNATION OF MATERIALS

COMPONENT DESIGNATION	MATERIALS
Friction washer	Molded resin carbon
	Carbographite
	Carbon impregnated with resin
	Silicon carbide
	Tungsten carbide (option)
	PTFE charged glass (optional)
Elastomer parts	Nitrile
	Ethylene propylene
	FPM
Metal part and spring	Stainless steel
Seat	Porous silicon carbide
	Stainless steel
	Silicon carbide
	Alumina (99% optional)
	Tungsten carbide (option)

For other materials, contact us.